

## 43' x 52' Tomcat Load Bearing Roof System

### Specifications

- Width: 43' -3"  
(40' - 0" Between Towers)
- Depth: 51'-11"  
(40' - 0" Between Towers)
- Max Trim Height: 30'-0"
- Towers: 12" x 12" Box Truss
- Front & Back Truss:  
Double Hung PRT
- Side Truss:  
20" x 30" Super Truss
- Intermediate Support:  
Double Hung PRT
- Lifting Style: 4 Motors
- White Vinyl Peaked Roof



### Options

- 5' -0" Cantilever off the Front or Back

This roof system is perfect for large shows. This versatile roof can be built most anywhere including, parking lots, terraces, or open fields. The system can also be used without the peaked roof in a grid type arrangement, if your event takes place inside a gymnasium or under a large tent.

The roof can be used with or without its integral lighting, if your event takes place during the day the roof can provide sun and rain protection for your performers.



Set Up Detail



Set Up Detail



Walworth County Fair - Elkhorn WI



Wisconsin Vally Fair - Wausau WI

IF IN DOUBT ASK

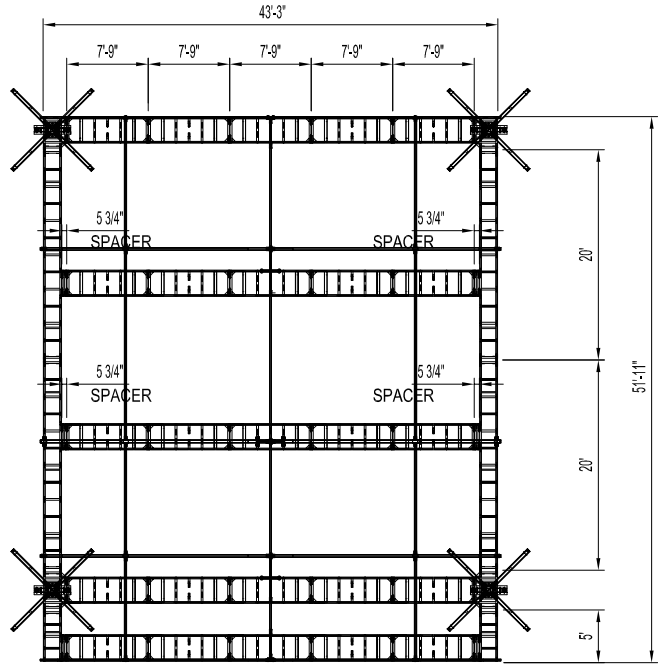

PLAN

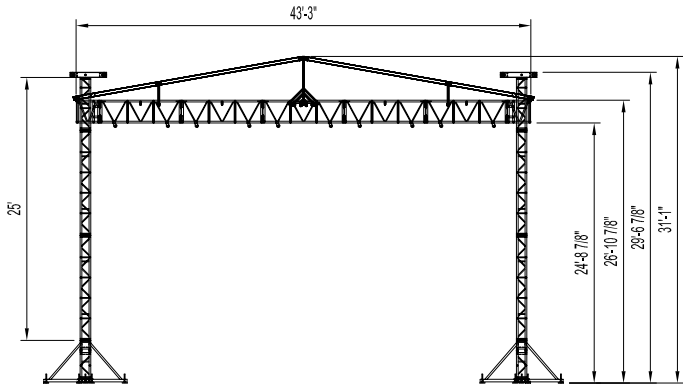

ELEVATION

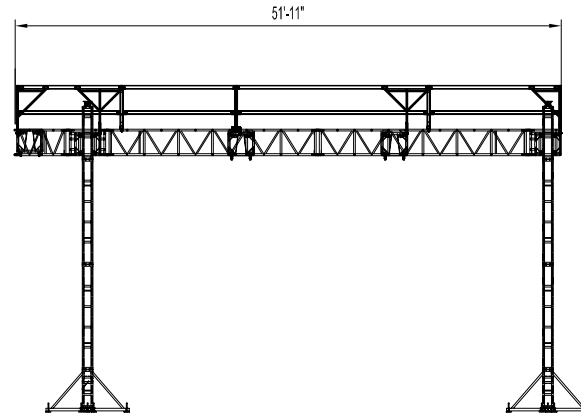

END

Approved  
 Approved As Noted  
 Revise and Resubmit  
 Rejected

Signed: \_\_\_\_\_

Date: \_\_\_\_\_

Approved  
 Revise and Resubmit  
 Rejected

Signed: \_\_\_\_\_  
 Date: \_\_\_\_\_

©  
**TOMCAT**  
 STAGING, LIGHTING AND SUPPORT SYSTEMS  
A TOMCAT Global Company

STRENGTH UNDER PRESSURE  
 IT'S ENGINEERED INTO  
 EVERYTHING WE DO

MADE IN THE  
**USA**

TOMCAT USA, INC.  
 P.O. BOX 550,  
 MIDLAND, TX,  
 79702, USA  
 TEL: 432-694-7070  
 FAX: 432-689-3805

DRAWN BY: J.GARCIA

DWG NO.: LHO-G2-A10

DATE: 07/17/07

SCALE: NTS

JOB NO.: 0756

PROJECT:  
 LIGHTHOUSE  
 RAFTER SYSTEM

TITLE:  
 CUSTOM PRT ROOF  
 GENERAL ARRANGEMENT

This drawing/document is copyright and the property of Tomcat USA, Inc. It must not be copied (in whole or in part) used for manufacture, or otherwise disclosed without written consent of the company. © TOMCAT USA, INC. 2007